

INSTALLATION INSTRUCTIONS

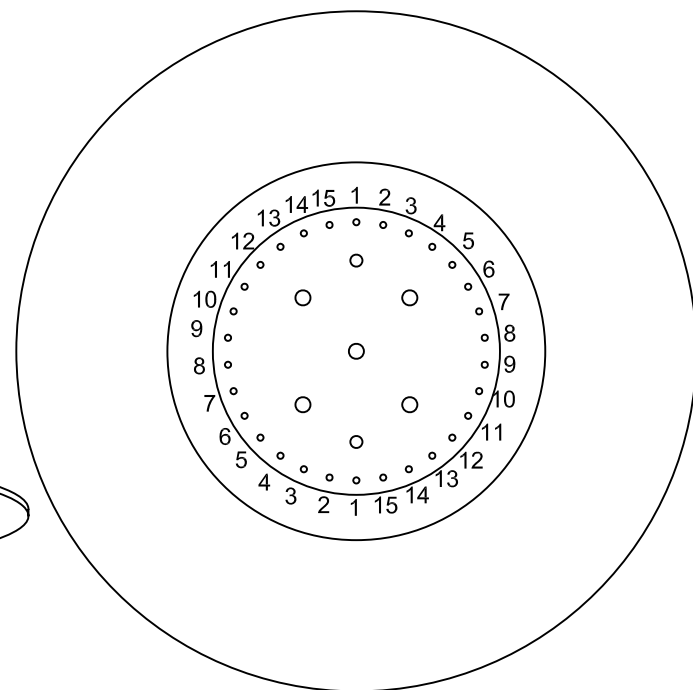
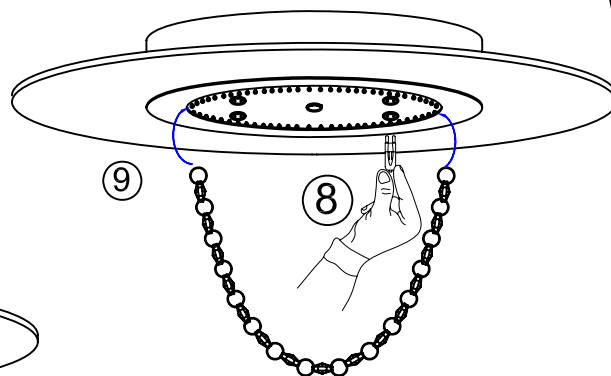
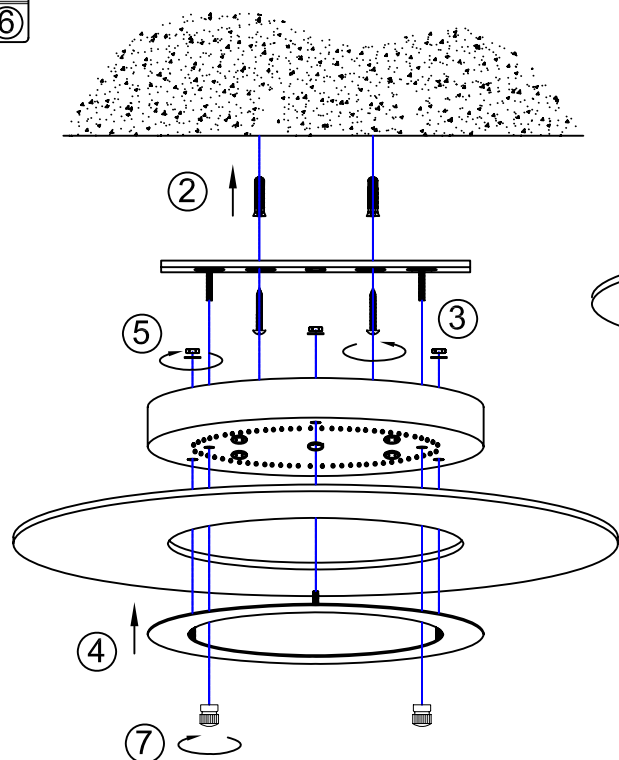
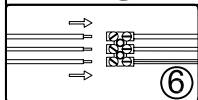
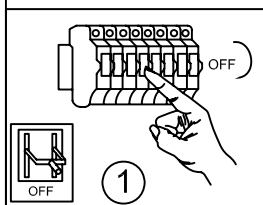

Installation Notes:

- 1: This luminaire is for indoor use only.
- 2: This luminaire requires an earth connection.
- 3: If you want to change a lamp, please switch off the luminaire and wait until lamps are cool.

Voltage: 230V
Lampholder: G9
lamp: 5 x MAX 40W
Frequency: 50Hz

REF:IL31460

diyas[®]

LIST OF COMPONENTS

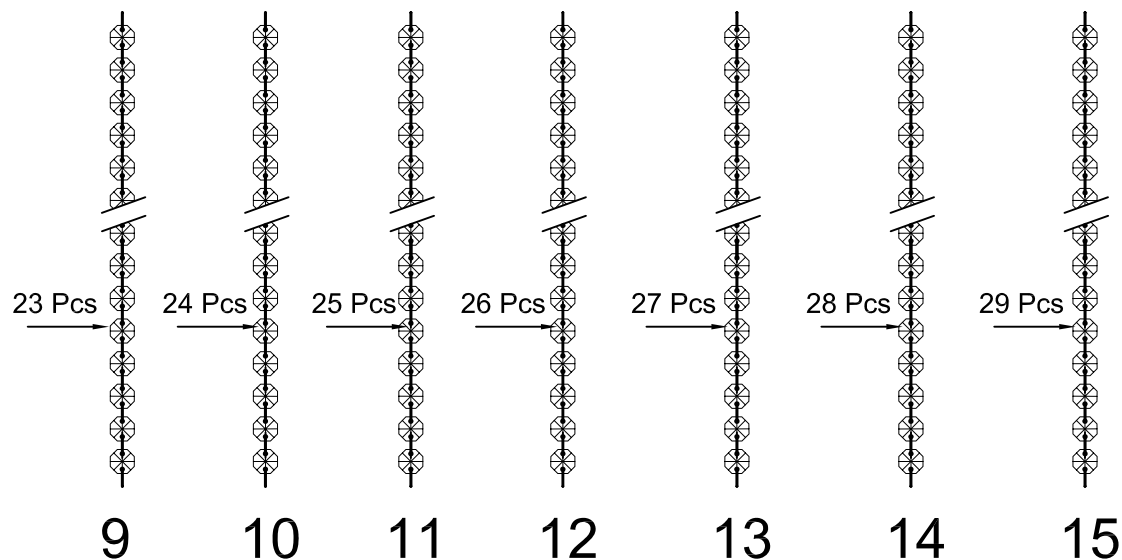
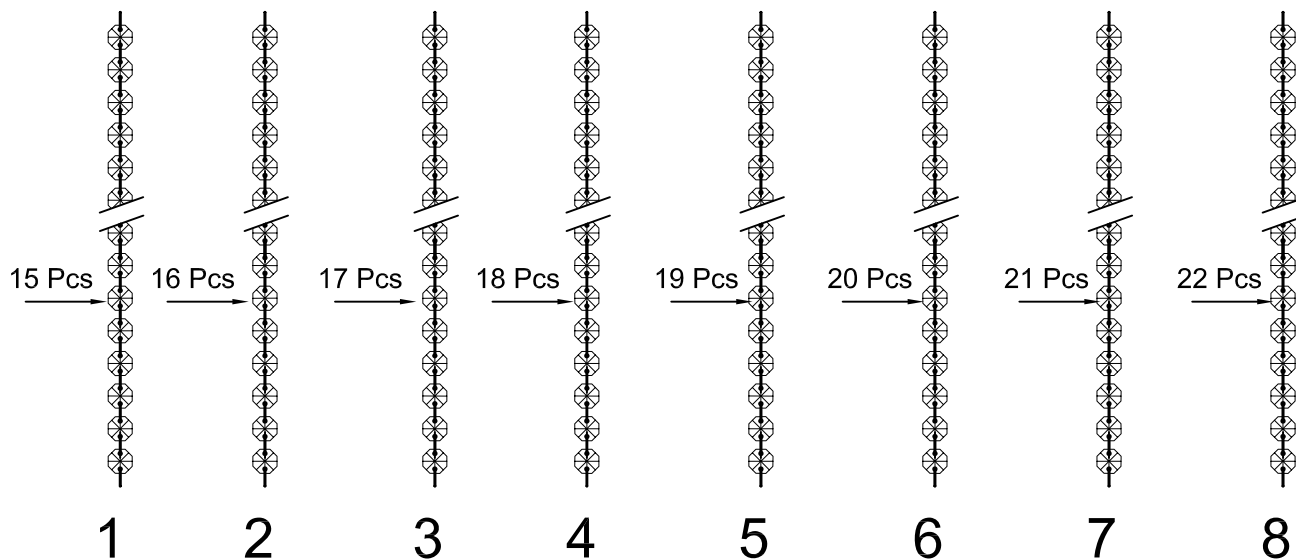

Crystal

1	1 Pc	10	1 Pc
2	1 Pc	11	1 Pc
3	1 Pc	12	1 Pc
4	1 Pc	13	1 Pc
5	1 Pc	14	1 Pc
6	1 Pc	15	1 Pc
7	1 Pc		
8	1 Pc		
9	1 Pc		

Installation Pack

White Gloves	2 Pcs
Assembly Instruction	2 Pcs
General Instruction Leaflet	1 Pc
FIXING SCREW AND PLUG	2 Sets
G9 lamp	5 Pcs

REF:IL31460

