

INSTALLATION INSTRUCTIONS

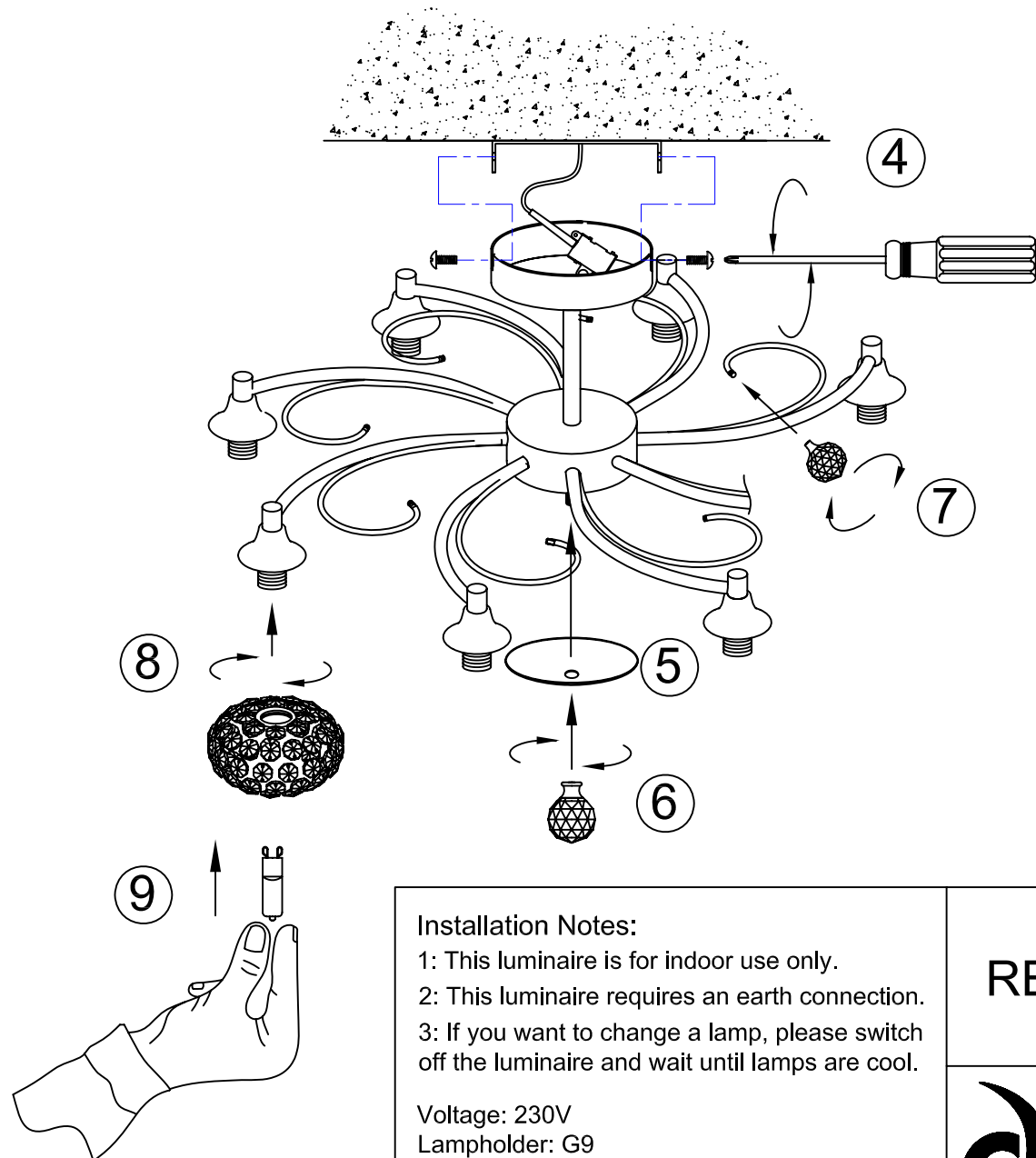
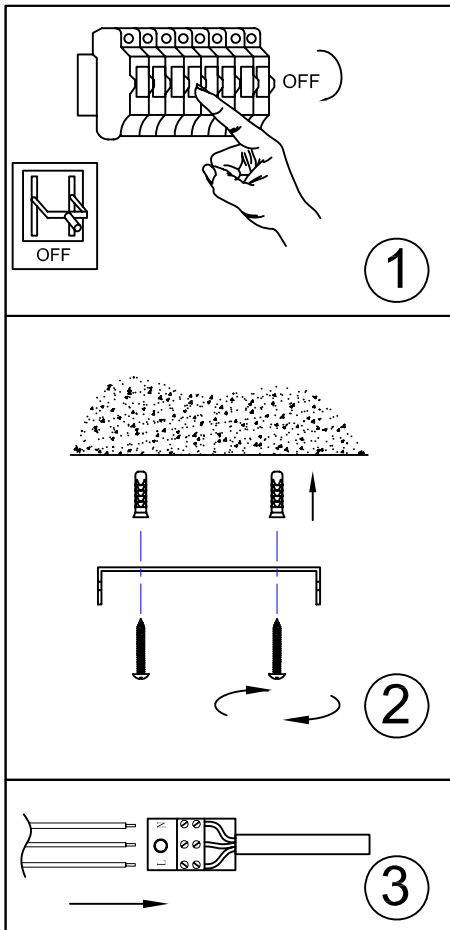

Issue:009131120

Installation Notes:

- 1: This luminaire is for indoor use only.
- 2: This luminaire requires an earth connection.
- 3: If you want to change a lamp, please switch off the luminaire and wait until lamps are cool.

Voltage: 230V
 Lampholder: G9
 Lamp: 8 x MAX 40W
 Frequency: 50Hz

REF:IL30938

diyas®

LIST OF COMPONENTS

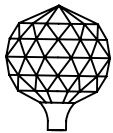

Crystal A

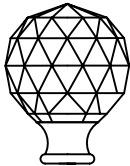

Crystal B

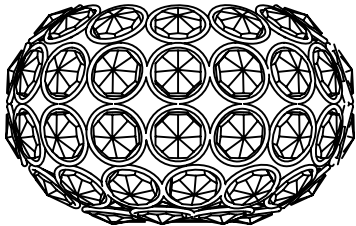

Shade

Issue:009131120

Crystal		
Crystal A	8 PCS	
Crystal B	1 PC	
Installation Pack		
Shade	8 PCS	
G9 Lamp	8 PCS	
White Gloves	2 PCS	
Assembly Instruction Leaflet	2 PCS	
General Instruction Leaflet	1 PC	
REF: IL30938		
<div>diyas®</div>		